

# WALCO CARGO CONTROL COMPONENTS

## WINCHES

H.D. Small Frame -----	Page 1
Portable -----	Page 1
Loose Frame -----	Page 1
Weld-on -----	Page 1
Low Profile -----	Page 1
Three Bar -----	Page 1
Slider Weld-on -----	Page 1
Lashing Winch -----	Page 2
Web Winder -----	Page 2
Winch Track -----	Page 2

## FLATBED ACCESSORIES

Winch Bars -----	Page 2
5 <sup>th</sup> Wheel Puller -----	Page 2
Rubber Tarp Ties -----	Page 2
S Hooks -----	Page 2
Corner Protectors -----	Page 2
Wear Sleeves -----	Page 2
Wheel Chocks -----	Page 2
Weld-on D rings -----	Page 2

## WINCH STRAPS

2" 3" Widths -----	Page 3
4" Width -----	Page 4

## RATCHET STRAP ASSEMBLIES

2" 3" 4" Widths -----	Page 5 & 6
-----------------------	------------

## SLINGS & ACCESSORIES

Wheel Tie Downs -----	Page 7
Towing Straps -----	Page 7
Round Slings -----	Page 7

## TRUCK LADDER

-----	Page 7
-------	--------

## WEB SLINGS

-----	Page 8
-------	--------

## LOAD BINDERS

-----	Page 9
Binder Locks -----	Page 9

## WIRE ROPE ASSEMBLIES

-----	Page 9
Wire Rope Clips -----	Page 9
Wire Rope Thimbles -----	Page 9
Swage Sleeve -----	Page 9

## CHAIN ASSEMBLIES

Bulk Chain -----	Page 10
Chain Assemblies -----	Page 10

## ACCESSORIES

Hooks – Grab & Slip -----	Page 10
Double Clevis Link -----	Page 10
Mid Link -----	Page 10
Anchor Shackle -----	Page 11
Eye Bolts -----	Page 11

## ACCESSORIES

Ratchet Buckles -----	Page 11
End Fittings & Hooks -----	Page 12
Rope Tie Off -----	Page 12
Snap Hook -----	Page 12
D Ring -----	Page 12
J hook -----	Page 12
Wire Hook -----	Page 12
Flat Hook -----	Page 12
Delta Ring -----	Page 12
Chain end w/ Hook -----	Page 12
Pan Fittings -----	Page 12
Door Pull Straps -----	Page 12
Floor Chain Tie Down -----	Page 12
Beam Socket -----	Page 12
Logistic Track -----	Page 13
Decking Beams -----	Page 13
Beam Heads & Pins -----	Page 13
Cargo Stays & Parts -----	Page 13
Shoring Bars -----	Page 13
Jack Bar -----	Page 13
Cargo Hoops -----	Page 13
Cargo Nets -----	Page 13

## LOGISTIC STRAPS 2"

-----Page 14

## UTILITY RATCHET STRAPS 1"

-----Page 14

## TIE DOWNS 1"

Cargo Straps Packaged -----	Page 15
Cargo Straps Display Stand -----	Page 16

## TIRE CHAIN AND ACCESSORIES

-----Page 17

Truck -----	
Fork Lift -----	
ATV -----	

Side Chain -----	
Cross chain -----	
Studded chain -----	
Cross chain hooks -----	
Repair Links -----	
Quick Links -----	
Tire chain Locks -----	

e-mail: [orders@walcoequipment.com](mailto:orders@walcoequipment.com)

**Walco Equipment has grown into a successful  
Canadian manufacturing & distribution Company.**

We have selected a wide range of durable Cargo Control products  
at competitive prices to meet your cargo securement needs.

**We strive to provide safety and service for our customers.**

**WORKING TOGETHER TO ENSURE A STRONG FUTURE**

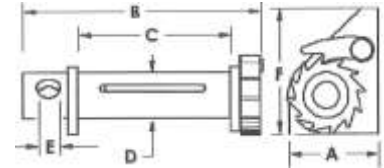

**WINCHES**

**H.D. WELD-ON  
SHORT SLIDER**

BLACK/ZINC



	A	B	C	D	E	F
	6-3/4"	7-3/4"	4-5/8"	1-7/8"	31/32"	3-7/8"
ITEM #				W.L.L.	WEIGHT	
649313	Solid Barrel Winch w/ washer - Black			6,000 lb./2,727 kg.	11 lb.	
649315	Solid Barrel Winch no washer - Black			6,000 lb./2,727 kg.		
649373	Solid Barrel Winch w/ washer - Zinc			6,000 lb./2,727 kg.		
649375	Solid Barrel Winch no washer - Zinc			6,000 lb./2,727 kg.		

**LONG FRAME  
H.D. SLIDER**



	A	B	C	D	E	F
	6-3/4"	10-3/8"	7-1/4"	1-7/8"	31/32"	3-7/8"
ITEM #				W.L.L.	WEIGHT	
649314	Solid Barrel Winch no washer - Black			6,000 lb./2,727 kg.	13 lb.	
649374	Solid Barrel Winch no washer - Zinc			6,000 lb./2,727 kg.		
649382	Solid Barrel Winch w/ washer - Zinc			6,000 lb./2,727 kg.		

**PORTABLE  
LOW PROFILE**

STANDARD



	A	B	C	D	E	F
	5"	7-3/4"	4-5/8"	1-7/8"	31/32"	3-7/8"
ITEM #				W.L.L.	WEIGHT	
649324	Low Profile - with set-screw			6,000 lb./2,727 kg.	9 lb.	

**LOOSE FRAME  
LOW PROFILE**



	A	B	C	D	E	F
	7"	7-3/4"	4-5/8"	1-7/8"	31/32"	3-7/8"
649360	Standard - with set screw			6,000 lb./2,727 kg.	10 lb.	

	A	B	C	D	E	F
	4"	7-1/2"	4-5/8"	1-7/8"	31/32"	5"
ITEM #				W.L.L.	WEIGHT	
649325	Loose Frame Weld-On			6,000 lb./2,727 kg.	6-1/4 lb.	

**STANDARD  
WELD-ON**



	A	B	C	D	E	F
	5-1/2"	8"	4-5/8"	1-7/8"	31/32"	3-7/8"
ITEM #				W.L.L.	WEIGHT	
649327	Standard Weld-On Winch			6,000 lb./2,727 kg.	8 lb.	

**LOW PROFILE  
WELD-ON**

SLIDE-ON



	A	B	C	D	E	F
	4-1/2"	8"	4-5/8"	1-7/8"	31/32"	3-7/8"
ITEM #				W.L.L.	WEIGHT	
649326	Low profile Weld-on			6,000 lbs./2,727 kg.	8 lb.	

	A	B	C	D	E	F
	3.94"	8"	4.86"	1-7/8"	31/32"	6"
649328	Low Profile Slider			6,000 lbs./2,727 kg		

**THREE BAR  
WELD-ON**

BOTTOM MOUNT



	A	B	C	D	E	F
	4"	10"	6-1/2"	2-3/8"	31/32"	3-7/8"
ITEM #				W.L.L.	WEIGHT	
649350	Side Mount - Weld-on - Painted			6,000 lb./2,727 kg.	12 lb.	
649351	Side Mount - Weld-on - Primed			6,000 lb./2,727 kg.	12 lb.	

	A	B	C	D	E	F
	5-1/2"	10"	6-1/2"	2-3/8"	31/32"	3-7/8"
649355	Low profile - Bottom Mount			6,000 lb./2,727 kg.	13 lb.	

	A	B	C	D	E	F
--	---	---	---	---	---	---



**LASHING WINCH**

ITEM #	BREAKING STRENGTH	W.L.L.	WEIGHT
649312	10,000 lb.	3,300 lb./ 1,510 kg.	3 lb.

This versatile tie-down has features of both a Winch and a Ratchet Buckle. It can be welded or bolted in place like a winch, but offers the quick release and easy operation of a ratchet buckle.

Uses a 1-1/8" socket. Drive (not included) Will accept up to 2" webbing

**WEB WINDER - PORTABLE**

ITEM #	WEIGHT
649301	3 lb.

Attach to truck rails. Dismount for storage. Wind 2, 3, & 4" webbing for compact storage

**WINCH TRACK**

ITEM #	WEIGHT
649305	38.5 lb.

**H.D. Steel Track**, designed for use with sliding winches. Available in standard 6-foot lengths.

**WINCH BARS**

ITEM #	
649306	Heavy Duty black painted winch bar. Weight - 4.25 lb. / 1.93 kg.
649308	Heavy Duty chrome winch bar. Weight - 4.75 lb. / 2.16 kg.
649309	Heavy Duty chrome combination winch bar. Heat treated, durable tapered nose. Length 35". Weight - 5.7 lb. / 2.59 kg.



**5th WHEEL PULLER**

ITEM #	LENGTH	WEIGHT
649300	28" Chrome	1.8 lb. / .82 kg.



**RUBBER TARP TIES with HOOKS**

ITEM #	LENGTH	WEIGHT /100
649602	9"	9.2 lb. / 4.18 kg.
649603	15"	11.5 lb. / 5.23 kg.
649604	21"	14.0 lb. / 6.36 kg.
649606	31"	17.5 lb. / 7.95 kg.
649607	41"	23.0 lb. / 10.45 kg.
649600	S Hooks for tarp ties	

**100 per case.** Made from ozone resistant and stretch resistant E.P.T. synthetic rubber.



**CORNER PROTECTORS**

**PLASTIC 12" PROTECTORS**



ITEM # 649462

Durable polyethylene corners protect tie down straps from damage and are required by law when road conditions could cause damage to tie down straps.

**PLASTIC PROTECTORS**



**2" to 4" WEBBING**  
Weight .02 lb.  
ITEM # 649460

**STEEL PROTECTORS**



**2" WEBBING, CABLE, CHAIN**  
Weight 1.3 lb.  
ITEM # 649329



**2" - 4" WEBBING**  
Weight 1.7 lb.  
ITEM # 649331

**WEAR SLEEVE**



Protects straps from cuts and abrasions. Wear sleeves sold per foot.

ITEM # 649105	for 2" strap
ITEM # 649106	for 3" strap
ITEM # 649097	for 4" strap
ITEM # 649107	Velcro, for 3"

**WHEEL CHOCKS**



ITEM #	DESCRIPTION
ITEM 649610	<b>"A" PYRAMID</b>
	• Durable rubber triangle
	• Maximum traction.
	• Reliable even on ice or snow.
	• Will not gouge tires, even if they are run over.
ITEM 649611	<b>"B" CONTOUR</b>

**D-RING - with weld-on mounting bracket**  
Self Colour



ITEM #	SIZE	BREAKING STRENGTH
649626	1/2"	12,000 lb./ 5,454 kg.
649632	5/8"	18,390 lb./ 8,454 kg.
649636	3/4"	26,500 lb./12,045 kg.
649638	1" Long	46,760 lb./21,254 kg.
649646	1" Short	" "
649645	1" Long Bent	" "

**2" WINCH STRAP**



ITEM #	LENGTH	WIRE HOOK	BREAKING STRENGTH	W.L.L.	CALIFORNIA RATING
649023	20'	1/2"	10,000 lb./ 4,545 kg.	3,300 lb./1,515 kg.	6,000 lb.
649026	25'	1/2"	10,000 lb./ 4,545 kg.	3,300 lb./1,515 kg.	6,000 lb.
649027	30'	1/2"	10,000 lb./ 4,545 kg.	3,300 lb./1,515 kg.	6,000 lb.
	20'	3/8"	10,000 lb./ 4,545 kg.	3,300 lb./1,515 kg.	6,000 lb.
	25'	3/8"	10,000 lb./ 4,545 kg.	3,300 lb./1,515 kg.	6,000 lb.
	30'	3/8"	10,000 lb./ 4,545 kg.	3,300 lb./1,515 kg.	6,000 lb.



ITEM #	LENGTH	FLAT HOOK	BREAKING STRENGTH	W.L.L.	CALIFORNIA RATING
649036	25'		10,000 lb./ 4,545 kg.	3,300 lb./1,515 kg.	6,000 lb.
649037	30'		10,000 lb./ 4,545 kg.	3,300 lb./1,515 kg.	6,000 lb.



ITEM #	LENGTH	DELTA RING	BREAKING STRENGTH	W.L.L.	CALIFORNIA RATING
649056	25'		10,000 lb./ 4,545 kg.	3,300 lbs./1,515 kg.	6,000 lb.
649057	30'		10,000 lb./ 4,545 kg.	3,300 lbs./1,515 kg.	6,000 lb.



ITEM #	LENGTH	SNAP HOOK	BREAKING STRENGTH	W.L.L.	CALIFORNIA RATING
649063	15'		10,000 lb./ 4,545 kg.	3,300 lb./1,515 kg.	6,000 lb.
649062	20'		10,000 lb./ 4,545 kg.	3,300 lb./1,515 kg.	6,000 lb.
649066	25'		10,000 lb./ 4,545 kg.	3,300 lb./1,515 kg.	6,000 lb.
649061	30'		10,000 lb./ 4,545 kg.	3,300 lb./1,515 kg.	6,000 lb.



ITEM #	LENGTH	CHAIN & GRAB	BREAKING STRENGTH	W.L.L.	CALIFORNIA RATING
649046	25'	5/16"	10,000 lb./ 4,545 kg.	3,300 lb./1,515 kg.	6,000 lb.
649047	30'		10,000 lb./ 4,545 kg.	3,300 lb./1,515 kg.	6,000 lb.

**3" WINCH STRAP**



ITEM #	LENGTH	WIRE HOOK	BREAKING STRENGTH	W.L.L.	CALIFORNIA RATING
649100	25'	5/8"	15,000 lb./ 6,818 kg.	5,000 lb./2,272 kg.	9,000 lb.
649102	30'		15,000 lb./ 6,818 kg.	5,000 lb./2,272 kg.	9,000 lb.



ITEM #	LENGTH	FLAT HOOK	BREAKING STRENGTH	W.L.L.	CALIFORNIA RATING
649110	25'		16,200 lb./ 6,818 kg.	5,400 lb./2,272 kg.	9,000 lb.
649112	30'		16,200 lb./ 6,818 kg.	5,400 lb./2,272 kg.	9,000 lb.



ITEM #	LENGTH	DELTA RING	BREAKING STRENGTH	W.L.L.	CALIFORNIA RATING
649130	30'		15,000 lb./ 6,818 kg.	5,000 lb./2,272 kg.	9,000 lb.



ITEM #	LENGTH	CHAIN & HOOK	BREAKING STRENGTH	W.L.L.	CALIFORNIA RATING
649120	25'	5/16"	15,000 lb./ 6,818 kg.	5,000 lb./2,272 kg.	9,000 lb.
649117	30'	5/16"	15,000 lb./ 6,818 kg.	5,000 lb./2,272 kg.	9,000 lb.
649124	40'	5/16"	15,000 lb./ 6,818 kg.	5,000 lb./2,272 kg.	9,000 lb.
649135	30'	3/8"	18,000 lb./8,181 kg.	6,000 lb./2,272 kg.	12,000 lb.
649133	30'	3/8" Grade 40	16,400 lb./7,439 kg.	5,400 lb./2,449 kg.	

**4" WINCH STRAP**

ITEM #	LENGTH	WIRE HOOK	BREAKING STRENGTH	W.L.L.	CALIFORNIA RATING
649199	30'	5/8"	20,000 lb./9,090 kg.	6,600 lb./3,000 kg.	12,000 lb.



ITEM #	LENGTH	FLAT HOOK	BREAKING STRENGTH	W.L.L.	CALIFORNIA RATING
649200	25'		20,000 lb./9,090 kg.	6,600 lb./3,000 kg.	12,000 lb.
649202	30'		20,000 lb./9,090 kg.	6,600 lb./3,000 kg.	12,000 lb.



ITEM #	LENGTH	DELTA RING	BREAKING STRENGTH	W.L.L.	CALIFORNIA RATING
649230	40'		20,000 lb./9,090 kg.	6,600 lb./3,000 kg.	12,000 lb.
649232	30'		20,000 lb./9,090 kg.	6,600 lb./3,000 kg.	12,000 lb.



ITEM #	LENGTH	CHAIN & HOOK	BREAKING STRENGTH	W.L.L.	CALIFORNIA RATING
649220	25'	3/8"	20,000 lb./9,090 kg.	6,000 lb./3,000kg.	12,000 lb.
649222	30'		20,000 lb./9,090 kg.	6,000 lb./3,000 kg.	12,000 lb.



ITEM #	LENGTH	LOOP	BREAKING STRENGTH	W.L.L.	CALIFORNIA RATING
	30'		18,000 lb./8,181 kg.	6,000 lb./2,727 kg.	12,000 lb.



ITEM #	LENGTH	GRAB HOOK	BREAKING STRENGTH	W.L.L.	CALIFORNIA RATING
649242	30'		16,200 lb./7,363 kg.	5,400 lb./2,454 kg.	



**2" RATCHET ASSEMBLY WITH LONG WIDE HANDLE**



COMPLETE RATCHET ASSEMBLY 2" X 27' AS SHOWN ABOVE

ITEM #	LENGTH	HOOK	BREAKING STRENGTH	W.L.L.
649075	27'	1/2" Wire Hooks	10,000 lb./4,545 kg.	3,300 lb./1,515 kg.
649077	27'	Flat Hooks	10,000 lb./4,545 kg.	3,300 lb./1,515 kg.
649079	27'	Chain End	10,000 lb./4,545 kg.	3,300 lb./1,515 kg.

WIRE HOOK



FLAT HOOK



DELTA RING



SNAP HOOK



CHAIN END



COMPLETE ITEM #	STRAP ONLY ITEM #	RATCHET W/TAIL ITEM #	LENGTH	HOOK	BREAKING STRENGTH	W.L.L.
649820	649023	649025	20'	1/2" Wire	10,000 lb./4,545 kg.	3,300 lb./1,515 kg.
	649026	649025	25'	1/2" Wire	10,000 lb./4,545 kg.	3,300 lb./1,515 kg.
649028	649027	649025	30'	1/2" Wire	10,000 lb./4,545 kg.	3,300 lb./1,515 kg.
649070		649850	20'	3/8" Wire	5,000 lb./ 2,272 kg.	1,666 lb. / 757 kg.
649828	649787	649850	25'	3/8" Wire	5,000 lb./ 2,272 kg.	1,666 lb. / 757 kg.
649072	649789	649850	30'	3/8" Wire	5,000 lb./ 2,272 kg.	1,666 lb. / 757 kg.
	649039	649035	20'	Flat	10,000 lb./4,545 kg.	3,300 lb./1,515 kg.
649821	649036	649035	25'	Flat	10,000 lb./4,545 kg.	3,300 lb./1,515 kg.
649822	649037	649035	30'	Flat	10,000 lb./4,545 kg.	3,300 lb./1,515 kg.
		649055	20'	Delta Ring	10,000 lb./4,545 kg.	3,300 lb./1,515 kg.
	649056	649055	25'	Delta Ring	10,000 lb./4,545 kg.	3,300 lb./1,515 kg.
	649057	649055	30'	Delta Ring	10,000 lb./4,545 kg.	3,300 lb./1,515 kg.
	649062	649060	20'	Snap	10,000 lb./4,545 kg.	3,300 lb./1,515 kg.
	649066	649060	25'	Snap	10,000 lb./4,545 kg.	3,300 lb./1,515 kg.
649825	649061	649060	30'	Snap	10,000 lb./4,545 kg.	3,300 lb./1,515 kg.
649823	649046	649045	25'	Chain End	10,000 lb./4,545 kg.	3,300 lb./1,515 kg.
649824	649047	649045	30'	Chain End	10,000 lb./4,545 kg.	3,300 lb./1,515 kg.

**2" RATCHET ASSEMBLY WITH SHORT WIDE HANDLE**



COMPLETE ITEM #	STRAP ONLY ITEM #	RATCHET W/TAIL ITEM #	LENGTH	HOOK	BREAKING STRENGTH	W.L.L.
	649023	649795	20'	1/2" Wire	10,000 lb./4,545 kg.	3,300 lb./1,515 kg.
	649026	649795	25'	1/2" Wire	10,000 lb./4,545 kg.	3,300 lb./1,515 kg.
	649027	649795	30'	1/2" Wire	10,000 lb./4,545 kg.	3,300 lb./1,515 kg.
649759		649763	20'	3/8" Wire	5,000 lb. / 2,272 kg.	1,666 lb./1,515 kg.
649760	649787	649763	25'	3/8" Wire	5,000 lb. / 2,272 kg.	1,666 lb./1,515 kg.
649762	649789	649763	30'	3/8" Wire	5,000 lb. / 2,272 kg.	1,666 lb./1,515 kg.
	649039		20'	Flat	10,000 lb./4,545 kg.	3,300 lb./1,515 kg.
	649036		25'	Flat	10,000 lb./4,545 kg.	3,300 lb./1,515 kg.
649793	649037		30'	Flat	10,000 lb./4,545 kg.	3,300 lb./1,515 kg.
			20'	Delta Ring	10,000 lb./4,545 kg.	3,300 lb./1,515 kg.
	649056		25'	Delta Ring	10,000 lb./4,545 kg.	3,300 lb./1,515 kg.
	649057		30'	Delta Ring	10,000 lb./4,545 kg.	3,300 lb./1,515 kg.
	649062		20'	Snap	10,000 lb./4,545 kg.	3,300 lb./1,515 kg.
	649066		25'	Snap	10,000 lb./4,545 kg.	3,300 lb./1,515 kg.
	649061		30'	Snap	10,000 lb./4,545 kg.	3,300 lb./1,515 kg.
	649046		25'	Chain End	10,000 lb./4,545 kg.	3,300 lb./1,515 kg.
649792	649047		30'	Chain End	10,000 lb./4,545 kg.	3,300 lb./1,515 kg.

**WORKING TOGETHER TO ENSURE A STRONG FUTURE**



**2" RATCHET ASSEMBLY SHORT NARROW HANDLE**

COMPLETE ASSEMBLY ITEM #	STRAP ONLY ITEM #	RATCHET W/TAIL ITEM #	LENGTH	HOOK	BREAKING STRENGTH	W.L.L.
	649023	649018	20'	1/2" Wire	10,000 lb./4,545 kg.	3,300 lb./ 4,545 kg.
	649026	649018	25'	1/2" Wire	10,000 lb./4,545 kg.	3,300 lb./ 4,545 kg.
	649027	649018	30'	1/2" Wire	10,000 lb./4,545 kg.	3,300 lb./ 4,545 kg.
	649788		20'	3/8" Wire	5,000 lb. /2,272 kg.	1,600 lb./ 757 kg.
649029	649787	649788	25'	3/8" Wire	5,000 lb. /2,272 kg.	1,600 lb./ 757 kg.
649791	649789	649788	30'	3/8" Wire	5,000 lb. /2,272 kg.	1,600 lb./ 757 kg.
	649039	649040	20'	Flat	10,000 lb./4,545 kg.	3,300 lb./4,545 kg.
	649036	649040	25'	Flat	10,000 lb./4,545 kg.	3,300 lb./4,545 kg.
	649037	649040	30'	Flat	10,000 lb./4,545 kg.	3,300 lb./4,545 kg.
			20'	Delta Ring	10,000 lb./4,545 kg.	3,300 lb./4,545 kg.
	649056		25'	Delta Ring	10,000 lb./4,545 kg.	3,300 lb./4,545 kg.
	649057		30'	Delta Ring	10,000 lb./4,545 kg.	3,300 lb./4,545 kg.
	649046		25'	Chain End	10,000 lb./4,545 kg.	3,300 lb./4,545 kg.
	649047		30'	Chain End	10,000 lb./4,545 kg.	3,300 lb./4,545 kg.



**3" RATCHET ASSEMBLY WITH LONG WIDE HANDLE**

COMPLETE ASSEMBLY ITEM #	STRAP ONLY ITEM #	RATCHET W/TAIL ITEM #	LENGTH	HOOK	BREAKING STRENGTH	W.L.L.
	649100	649099	25'	Grab Hook	15,000 lb./6,818 kg.	5,000 lb./2,272 kg.
			30'	Grab Hook	15,000 lb./6,818 kg.	5,000 lb./2,272 kg.
649127	649120	649121	25'	Chain End	15,000 lb./6,818 kg.	5,000 lb./2,272 kg.
	649122	649099	30'	1/2" Wire	15,000 lb./6,818 kg.	5,000 lb./2,272 kg.
	649102	649099	30'	1/2" Wire	15,000 lb./6,818 kg.	5,000 lb./2,272 kg.
	649110	649111	25'	Flat	16,200 lb./6,818 kg.	5,400 lb./2,272 kg.
649826	649112	649111	30'	Flat	16,200 lb./6,818 kg.	5,400 lb./2,272 kg.
			25'	Delta Ring	15,000 lb./6,818 kg.	5,000 lb./2,272 kg.
	649130		30'	Delta Ring	15,000 lb./6,818 kg.	5,000 lb./2,272 kg.
			25'	Snap Hook	15,000 lb./6,818 kg.	5,000 lb./2,272 kg.
			30'	Snap Hook	15,000 lb./6,818 kg.	5,000 lb./2,272 kg.



**4" RATCHET ASSEMBLY WITH LONG WIDE HANDLE**

COMPLETE ASSEMBLY ITEM #	STRAP ONLY ITEM #	RATCHET W/TAIL ITEM #	LENGTH	HOOK	BREAKING STRENGTH	W.L.L.
	649200	649201	25'	Flat	20,000 lb./9,090 kg.	6,600 lb./3,000 kg.
649829	649202	649201	30'	Flat	20,000 lb./9,090 kg.	6,600 lb./3,000 kg.
			25'	Delta Ring	20,000 lb./9,090 kg.	6,600 lb./9,090 kg.
	649232		30'	Delta Ring	20,000 lb./9,090 kg.	6,600 lb./3,000 kg.
	649220	649221	25'	Chain End	20,000 lb./9,090 kg.	6,600 lb./9,090 kg.
649830	649222	649221	30'	Chain End	20,000 lb./9,090 kg.	6,600 lb./3,000 kg.



**ADJUSTABLE WHEEL TIE-DOWNS**

ITEM #	W.L.L.	TIRE SIZE	BREAK STRENGTH
649854	1,666 lb.	15 - 16"	5,000 lb.
649855	754 kg	13 - 14"	2,272 kg

This wheel harness allows you to safely haul a wide variety of vehicles.



**TOWING STRAPS**

ITEM	SIZE	W.L.L.
649091	2" x 20'	
649092		3" x 20'
649093	4" x 20'	
649094		4" x 30'

Single ply towing strap with twisted eye and eye.



**ROUND SLING**

CODE #	COLOUR	VERTICAL	CHOKER	BASKET
SL-30	Purple	3,000 lb.	2,400 lb.	6,000
SL-40	Black	4,000	3,200	8,000
SL-60	Green lbs.	6,000 lb.	4,800 lb.	12,000
SL-90	Yellow	9,000	7,200	18,000
SL-120	Tan	12,000	9,600	24,000
SL-1430	Red	14,000 lb.	11,200 lb.	28,000
SL-170	Orange	17,000	13,600	34,000
SL-230	Blue	23,000	18,400	46,000
SL-260	Orange	26,000	20,800	52,000
SL-320	Grey	32,000 lb.	25,600 lb.	64,000
SL-400	Orange	40,000	32,000	80,000
SL-540	Orange	54,000	43,200	108,000
SL-680	Orange	68,000	54,400	136,000
SL-900	Orange	90,000	72,000	180,000

Constructed from a multiple of high tenacity polyester yarns in an endless loop, covered with a woven polyester jacket. Hook and load points can be rotated to extend the life of the sling. Polyester cover protects the inner fibres from wear, and the load from sling damage, reducing the need for wear pads.



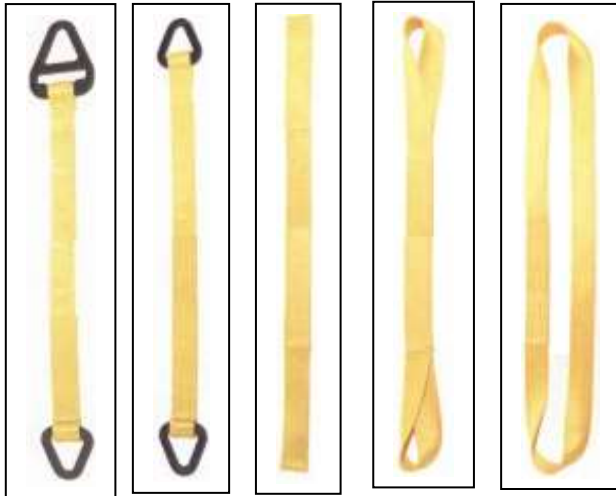

TYPE 1 TC      TYPE 2 TT      TYPE 3 EE      TYPE 4 EE      TYPE 5 EN

**WEB SLINGS**



VERTICAL      CHOKER      BASKET

**SINGLE PLY**

**DOUBLE PLY**

WIDTH	REFERENCE #	VERTICAL	CHOKER	BASKET	REFERENCE #	VERTICAL	CHOKER	BASKET
1"	EE1-901-T3	1600	1280	3200	EE2-901-T3	3100	2400	6400
1"	EE1-901-T4	1600	1280	3200	EE2-901-T4	3100	2400	6400
1"	EN1-901	3200	2560	6400	EN2-901	6200	4960	12,400
2"	TC1-902	3100	2480	6200	TC2-902	6200	4960	12,400
2"	TT1-902	3100		6200	TT2-902	6200		12,400
2"	EE1-902-T3	3100	2480	6200	EE2-902-T3	6200	4960	12,400
2"	EE1-902-T4	3100	2480	6200	EE2-902-T4	6200	4960	12,400
2"	EN1-902	6200	4960	12,400	EN2-902	12,400	9920	24,800
3"	TC1-903	4700	3760	9400	TC2-903	8800	7040	17,600
3"	TT1-903	4700		9400	TT2-903	8800		17,600
3"	EE1-903-T3	4700	3760	9400	EE2-903-T3	8800	7040	17,600
3"	EE1-903-T4	4700	3760	9400	EE2-903-T4	8800	7040	17,600
3"	EN1-903	9400	7520	18,800	EN2-903	17,600	14,080	35,200
4"	TC1-904	6200	4960	11,400	TC2-904	11,000	8800	22,000
4"	TT1-904	6200		11,400	TT2-904	11,000		22,000
4"	EE1-904-T3	6200	4960	11,400	EE2-904-T3	11,000	8800	22,000
4"	EE1-904-T4	6200	4960	11,400	EE2-904-T4	11,000	8800	22,000
4"	EN1-904	12,400	9920	24,800	EN2-904	22,000	17,600	44,000
5"	TC1-905	7800	6240	16,000	TC2-905	13,700	10,300	27,400
5"	TT1-905	7800		16,000	TT2-905	13,700		27,400
5"	EE1-905-T3	7800	6240	16,000	EE2-905-T3	13,700	10,300	27,400
5"	EE1-905-T4	7800	6240	16,000	EE2-905-T4	13,700	10,300	27,400
5"	EN1-905	15,000	12,000	30,000	EN2-905	27,500	22,000	55,000
6"	TC1-906	9300	7440	18,600	TC2-906	16,500	13,200	33,000
6"	TT1-906	9300		18,600	TT2-906	16,500		33,000
6"	EE1-906-T3	9300	7440	18,600	EE2-906-T3	16,500	13,200	33,000
6"	EE1-906-T4	9300	7440	18,600	EE2-906-T4	16,500	13,200	33,000
6"	EN1-906	18,600	14,880	37,200	EN2-906	33,000	26,400	66,000
8"	TC1-908	11,750	9400	23,500	TC2-908	22,750	18,200	45,500
8"	TT1-908	11,750		23,500	TT2-908	22,750		45,500
8"	EE1-908-T3	11,750	9400	23,500	EE2-908-T3	22,750	18,200	45,500
8"	EE1-908-T4	11,750	9400	23,500	EE2-908-T4	22,750	18,200	45,500
8"	EN1-908	21,150	16,920	42,300	EN2-908	42,350	33,880	84,700
10"	TC1-910	14,700	11,760	29,400	TC2-910	28,400	22,720	46,800
10"	TT1-910	14,700		29,400	TT2-910	28,400		46,800
10"	EE1-910-T3	14,700	11,760	29,400	EE2-910-T3	28,400	22,720	46,800
10"	EE1-910-T4	14,700	11,760	29,400	EE2-910-T4	28,400	22,720	46,800
10"	EN1-910	26,450	21,160	52,900	EN2-910	52,900	42,320	105,800
12"	TC1-912	17,650	14,120	35,300	TC2-912	34,100	27,280	68,200
12"	TT1-912	17,650		35,300	TT2-912	34,100		68,200
12"	EE1-912-T3	17,650	14,120	35,300	EE2-912-T3	34,100	27,280	68,200
12"	EE1-912-T4	17,650	14,120	35,300	EE2-912-T4	34,100	27,280	68,200
12"	EN1-912	31,750	25,400	63,500	EN2-912	63,500	50,800	127,000

**WORKING TOGETHER TO ENSURE A STRONG FUTURE**



**BINDER LOCK (YELLOW)**

**ITEM #**

649635 A simple and effective way of keeping binders secure.

**STANDARD LOAD BINDER**

ITEM #		W.L.L./LB.
604128	Standard Load Binder 1/4 – 5/16 Gr. 70	2600
604132	Standard Load Binder 5/16 – 3/8 Gr.70	6600
604140	Standard Load Binder 3/8 – 1/2 Gr.70	9200

Lever type binder with swivel hooks.  
Take up slack and apply tension to tie down system.  
Drop forged steel – Heat treated

**SAFETY LOAD BINDER**

ITEM #		W.L.L./LB.
604160	Safety load binder 5/16 – 3/8 Gr. 70	5400

Special handle prevents finger trap and allows easy release.  
Drop forged steel – Heat treated

**RATCHET LOAD BINDER**

ITEM #		W.L.L./LB.
604161	Ratchet load binder 5/16 – 3/8	5400
604162	Ratchet load binder 3/8 – 1/2	9200
604163	Ratchet load binder 1/2 - 5/8	13,000

No handle locking required.  
Short reach hooks provide optimum take up.  
Drop forged construction.

**WIRE ROPE ASSEMBLY ♦♦ WIRE ROPE AVAILABLE IN BULK ♦♦**

ITEM #	WIRE SIZE		LENGTH	HOOK	W.L.L.
60508	1/4"	Stainless	30' 1	Grab w/Chain end	1,050 kg.
605510	1/4"	Galvanized	30' 1	Grab w/Chain end	1,050 kg.
605511	1/4"	Galvanized	32' 1	Grab w/Chain end	1,050 kg.
605514	5/16"	Galvanized	30' 1	Grab w/Chain end	1,500 kg.
605515	1/4"	Galvanized	30' 1	Grab w/Chain end	1,050 kg.

W.L.L. STAMPED ON FURREL. OTHER CONFIGURATIONS AVAILABLE.

**WIRE ROPE CLIP GALVANIZED MALLEABLE**

ITEM #	CABLE DIAMETER	WEIGHT / 100
503419	3/16'	6 lb.
503420	1/4"	10 lb.
503421	5/16"	12 lb.
503422	3/8"	40 lb.

AVAILABLE IN "DROP FORGED"

**WIRE ROPE THIMBLE - ZINC**

ITEM #	CABLE DIAMETER	WEIGHT / 100
604319	3/16	2.5 lb.
604320	1/4	2.5 lb.
604322	5/16	4.4 lb.
604324	3/8	7.6 lb.
604326	1/2"	AVAILABLE IN OTHER SIZES.

**SWAGE SLEEVES - ALUMINUM**

ITEM #	CABLE DIAMETER	TYPE
604366	3/16	Oval
604364	3/16	Stop
604368	3/16	Spools
604369	1/4	Oval
604376	1/4	Stop
604370	5/16	Oval
604371	3/8	Oval

**BULK CHAIN GRADE 30 – HIGH TEST – SELF COLOUR**

ITEM #	CHAIN SIZE	WIRE DIAMETER	INSIDE LK. LENGTH	INSIDE LK. WIDTH	DRUM QTY.	W.L.L.
600125	3/16"	.188	.98"	.41	1600'	600 lb.
600127	1/4"	.250	1.05"	.49"	900'	1050 lb.
600008	5/16"	.312	1.19"	.49"	550'	1700 lb.
600010	3/8"	.375	1.29"	.61"	400'	2400 lb.
600013	1/2"	.492	2.05"	.88"	250'	4150 lb.



**GRADE 40 & BRIGHT ZINC AVAILABLE**

**BULK CHAIN GRADE 70 - YELLOW DICHROMATE**

ITEM #	CHAIN SIZE	WIRE LENGTH	INSIDE LK. LENGTH	INSIDE LK. WIDTH	DRUM QTY.	W.L.L.
601027	1/4"	.281	.85"	.41"	800'	3,150 lb.
601028	5/16"	.343	.92"	.47"	550'	4,700 lb.
601029	3/8"	.394	1.15"	.57"	400'	6,600 lb.
601030	1/2"	.519	1.50"	.80"	98'	11,300 lb.
601032	5/8"	.618	2.23	.808"	100	15,800 lb.



High strength, lightweight chain, designed for the trucking industry. Embossed "W7"

**CHAIN ASSEMBLIES GRADE 70**

ITEM #	SIZE	LENGTH	HOOKS	W.L.L.
601088	5/16"	16'	2 Grab Hooks	4,700 lb.
601089	5/16"	20'	2 Grab Hooks	4,700 lb.
601090	5/16"	25'	2 Grab Hooks	4,700 lb.
601105	3/8"	16'	2 Grab Hooks	6,600 lb.
601114	3/8"	20'	2 Grab Hooks	6,600 lb.
601113	3/8"	25'	2 Grab Hooks	6,600 lb.



**OTHER SIZES AND HOOKS AVAILABLE**

**CLEVIS GRAB HOOK GRADE 40 - CARBON STEEL**

ITEM #	SIZE	WEIGHT PER 100	W.L.L.
604102	1/4"	43 lb.	2,600 lb.
604103	5/16"	73 lb.	3,900 lb.
604115	3/8"	121 lb.	5,400 lb.
604116	1/2"	220 lb.	9,200 lb.



**CLEVIS GRAB HOOK GRADE 70 - ALLOY STEEL**

ITEM #	SIZE	WEIGHT PER 100	W.L.L.
604101	1/4"	43 lbs.	3,150 lb.
604168	5/16"	76 lbs.	4,700 lb.
604110	3/8"	121 lbs.	6,600 lb.
604114	1/2"	220 lbs.	11,300 lb.



**CLEVIS SLIP HOOK GRADE 70 - ALLOY STEEL**

ITEM #	SIZE	WEIGHT PER 100	W.L.L.
604099	1/4"		2,750 lb.
604169	5/16"		4,300 lb.
604106	3/8"		5,250 lb.
604118	1/2"		9,200 lb.



**CLEVIS SLIP HOOK WITH LATCH GRADE 70**

ITEM #	SIZE	WEIGHT
604060	1/4"	.60 lb.
604062	5/16"	.81 lb.
604064	3/8"	1.32 lb.
604066	1/2"	1.5 lb.
604012	5/8"	



**MID LINK GRADE 70 - ZINC PLATED**

ITEM #	CHAIN END	LARGE END	WEIGHT PER 100	W.L.L.
604305	1/4	5/16	44 lb.	4,700
604308	5/16	3/8	87.5 lb.	6,600
604309	3/8	1/2	184 lb.	11,300



**DOUBLE CLEVIS LINK GRADE 70 - ZINC PLATED**

ITEM #	LINK SIZE	WEIGHT PER 100	W.L.L.
604306	1/4 - 5/16	33 lb.	4,700
604310	3/8	45 lb.	6,600
604311	1/2	100 lb.	11,300



**ANCHOR SHACKLE SCREW PIN**

ITEM #	SIZE	PIN SIZE	WEIGHT/100	W.L.L./TONS
604164	3/16	1/4	6 lb.	1/3
604208	1/4	5/16	12 lb.	1/2
604214	5/16	3/8	20 lb.	3/4
604210	3/8	7/16	30 lb.	1
604211	7/16	1/2	50 lb.	1-1/2
604213	1/2	5/8	75 lb.	2
604216	5/8	3/4	130 lb.	3-1/4
604219	3/4	7/8	225 lb.	4-3/5
604220	7/8	1"	350 lb.	6-1/2



Regular Eye Bolts Available  
1/2" - 5/8" - 3/4"  
8", 10" & 12" long

**EYE BOLTS SHOULDER TYPE**

ITEM #	SIZE	TYPE	WEIGHT	W.L.L.
606005	1/4 x 2"	Shoulder	.06	500 lb.
	1/4 x 4"	Shoulder	.09	500 lb.
606008	5/16 x 2-1/4"	Shoulder	.11	800 lb.
	5/16 x 4-1/4"	Shoulder	.15	800 lb.
606014	1/2 x 6"	Shoulder	.68	2200 lb.
606015	5/8 X 6"	Shoulder	1	3500 lb.

DO NOT EXCEED WORKING LOAD LIMIT  
NEVER INSERT ONLY POINT OF HOOK. ALWAYS USE A SHACKLE.

**RATCHET BUCKLES**

ITEM #	SIZE	W.L.L.	BREAKING STRENGTH
930029	2" Ratchet	1466 lb./666 kg.	4,000 lb./2000 kg.

ITEM #	SIZE	W.L.L.	BREAKING STRENGTH
930028	2" Ratchet - Short Narrow	3666 lb./1666 kg.	11,000 lb./5,000 kg.

ITEM #	SIZE	W.L.L.	BREAKING STRENGTH
649410	2" Ratchet - Short Wide Handle	3666 lb./1666 kg.	11,000 lb./5,000 kg.

ITEM #	SIZE	W.L.L.	BREAKING STRENGTH
649407	2" Ratchet - Wide Handle	3666 lb./1666 kg.	11,000 lb./5,000 kg.

ITEM #	SIZE	W.L.L.	BREAKING STRENGTH
649408	3" Ratchet - Long Wide Handle	7333 lb./3333 kg.	22,000 lb./10,000

ITEM #	SIZE	W.L.L.	BREAKING STRENGTH
930030	4" Ratchet - Long Wide Handle	8000 lb./3636 kg.	24,000 lb./11,000 kg.

ITEM #	SIZE	W.L.L.	BREAKING STRENGTH
649409	1" Ratchet - Wide Handle	1100 lb./500 kg.	3300 lb./1500 kg.

ITEM #	SIZE	W.L.L.	BREAKING STRENGTH
930031	1" Cam Buckle	500 lb./227 kg.	1500 lb./ 681 kg.
930034	2" Cam Buckle	1000 lb./454 kg.	3000 lb./1363 kg.

ITEM #	SIZE	W.L.L.	BREAKING STRENGTH
930035	2" Over-Center Buckle	1100 lb./500 kg.	3300 lb./1500 kg.





**ACCESSORIES**

**SPRING "E" FITTINGS**

ITEM #	SIZE	BREAKING STRENGTH
930041	2"	4500 lb. / 2045 kg.



**ROPE TIE OFF**

"F" FITTING & WIRE HOOK AVAILABLE

ITEM #	CORD TIE OFF	W.L.L.
649540	with E Spring Fitting	1170 lb.



**BUTTERFLY "F" FITTING**

ITEM #	SIZE	BREAKING STRENGTH
930050	1" hole	1500 lb. / 380kg.



**SPRING "E" FITTING with RING**

ITEM #	SIZE	BREAKING STRENGTH
649541	2"	4500 lb. / 2045 kg.



**SNAP HOOK**

ITEM #	
930040	for 2" strap



**"J" HOOK - Plastic Coated**

ITEM #	SIZE	BREAKING STRENGTH
930015	1"	2500 lb. / 1100kg.



**D RINGS**

ITEM #	
930046	2" D Ring
930043	1" D Ring



**WIRE HOOKS**

ITEM #	
930022	5/8" for 3" strap
930020	1/2" for 2' strap
930018	3/8" for 2" strap
930017	1/4" for 2" strap
930016	1/4" for 1" strap



**FLAT HOOKS**

ITEM #	
930032	for 4" strap
930023	for 3" strap
930021	for 2" strap



**DELTA RING**

ITEM #	
930014	for 4" strap
930013	for 3" strap
930012	for 2" strap



**CHAIN END**

ITEM #	
930007	4" Chain end Grade 70
930006	3" Chain end Grade 70
930005	2" Chain end Grade 70

**RECESSED FLOOR ANCHOR RING**

ITEM #	DESCRIPTION	BREAKING STRENGTH
649620	Ring Kit - recessed with square base	5,000 lb.
649621	Ring Kit - recessed with back plate and bolts H.D.	



**DOOR PULL STRAP**

ITEM #	SIZE	DESCRIPTION
649554	18"	For overhead or side doors
649555	24"	and access to wheel carts.
649556	36"	



**FLOOR CHAIN TIE DOWN**

ITEM #	DESCRIPTION	W.L.L.
650613	Floor chain tie-down Welded to trailer cross member. Unit sits flush to the floor. Pull on cap to expose chain. For use on steel frame trailer, with standard hard wood floor.	5400 lb.



**BEAM SOCKET**

ITEM #	DESCRIPTION
649430	Zinc plated, with locking mechanism Use with 2" x 6' commercial grade lumber. W.L.L. varies depending on quality of lumber.



**LOGISTIC TRACK**

**COMBI "E & F" TRACK – GALVANIZED – 10 ft.**

ITEM #	DESCRIPTION
649399	Material: High strength 12-gauge steel Minimum Yield: 43,000 psi Weight: 17 lbs. / 7.7kg. Length: 10 feet / 3m
649400	Standard Series E Track - available on request

**SERIES "F" TRACK – GALVANIZED – 10 ft.**

ITEM #	DESCRIPTION
649406	Material: High strength 14-gauge steel Minimum Yield: 43,000 psi Weight: 7.6 lbs. / 3.4 kg.

**SERIES "L" TRACK - GALVANIZED- 10 ft.**

ITEM #	DESCRIPTION
649405	Material: High strength 12-gauge steel Minimum Yield: 50,000 psi Weight: 12 lbs. / 5.4 kg.

**CAUTION:** Welding of galvanized track should be done only in a well ventilated area to avoid toxic fumes.

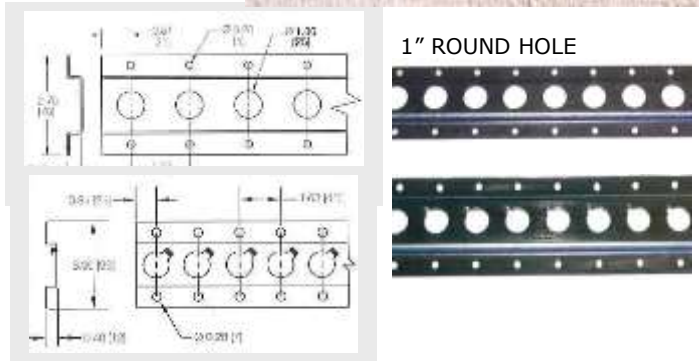

**BEAM PIN**

**BEAM HEAD**

**ALUMINUM / ALL STEEL / ALL STEEL EXTRA LONG**



**RACK ASSEMBLY**

**CARGO STAY FOOT**

**1" ROUND SERIES "E"**



**1" SQUARE "F" SERIES**

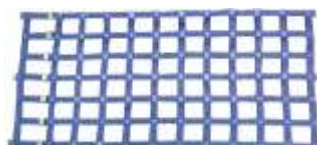
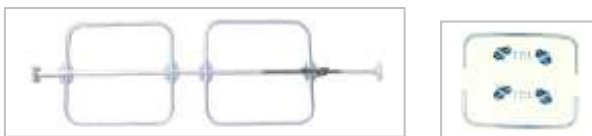

**WALCO DECKING BEAMS - ALUMINUM**

ITEM #	DESCRIPTION	W.L.L. 2000 LB.
649415	Adjustment Range: 90.8" – 101.7". Decking / Vertical Weight 21 lb. 606 1T6 Head Assemblies are all steel, Zinc plated. Tapered for ease of operation.	
930551	Replacement Pin for decking beam socket.	
930550	Beam Head	

**CARGO STAYS - HEAT TREATED ALUMINUM**

ITEM #	DESCRIPTION
649427	1-1/2" dia. Adjusts from 89.75 to 104.5" Moulded rubber feet for firm grip.
649424	Rack, lever and housing assembly
649422	Large foot - each
649421	Small Foot - each

**SHORING BAR - GALVANIZED**

ITEM #	DESCRIPTION	SUPPORTS 500 LB.
649436	Spring-load designed for quick installation. H.D. Adjusts from 93" to 108". Weight 21 lb.	

**WARNING** Do not use shoring bar in decking applications.

**SHORING BAR - GALVANIZED**

ITEM #	DESCRIPTION	SUPPORTS 1000LB.
649420	Easy installation Adjusts from 89" to 104". Weight 27 lb.	

**WARNING** Do not use shoring bar in decking applications.

**JACK BARS Heavy-duty universal square bar.**

ITEM #	DESCRIPTION
649419	Adjusts 86" - 104" Bolt-on non-slip feet. Ideal for shoring, and most other interior van applications.

**CARGO HOOP SET**

ITEM #	DESCRIPTION	WEIGHT (SINGLE) 10 LB.
649426	Hoop dimensions 26.75 x 28.25 For use on aluminum and steel cargo bars, To hold a larger surface area. For interior shoring applications.	

**CARGO NETS**

ITEM #	DESCRIPTION	W.L.L.
	1-inch webbing	500 lb. / 227 kg.
	2-inch webbing	1000 lb. / 454 kg.

Custom made to your specifications. Attach to van walls by adjustable buckles and "E" fittings, or snaps or wire hooks.

Yellow Straps  
12' long



Grey Straps  
16' long



Blue Straps  
20' long



**2" LOGISTIC STRAPS**

with Ratchet Buckle for light to medium loads.  
All logistic straps have a 4' fixed end.

ITEM #	STRAP LENGTH	END HARDWARE	W.L.L.	BREAKING STRENGTH
649500	12'	"E" Fitting	1500 lb.	4500 lb.
649501	16'	"E" Fitting	1500 lb.	4500 lb.
649502	20'	"E" Fitting	1500 lb.	4500 lb.

649750	12'	Wire Hook	500 lb.	1500 lb.
649752	16'	Wire Hook	500 lb.	1500 lb.
649754	20'	Wire Hook	500 lb.	1500 lb.

649546	12'	"F" Butterfly	420 lb.	1250 lb.
649544	16'	"F" Butterfly	420 lb.	1250 lb.
649545	20'	"F" Butterfly	420 lb.	1250 lb.

**2" LOGISTIC STRAPS**

WITH CAM BUCKLE

ITEM #	STRAP LENGTH	END HARDWARE	W.L.L.	BREAKING STRENGTH
649510	12'	"E" Fitting	835 lb.	2500 lb.
649511	16'	"E" Fitting	835 lb.	2500 lb.
649512	20'	"E" Fitting	835 lb.	2500 lb.

649566	12'	Wire Hook	500 lb.	1500 lb.
649568	16'	Wire Hook	500 lb.	1500 lb.
649570	20'	Wire Hook	500 lb.	1500 lb.

649560	12'	"F" Butterfly	420 lb.	1250 lb.
649562	16'	"F" Butterfly	420 lb.	1250 lb.
649564	20'	"F" Butterfly	420 lb.	1250 lb.

**2" LOGISTIC STRAPS**

WITH OVER-CENTER BUCKLE

ITEM #	STRAP LENGTH	END HARDWARE	W.L.L.	BREAKING STRENGTH
649520	12'	"E" Fitting	1500 lb.	4500 lb.
649521	16'	"E" Fitting	1500 lb.	4500 lb.
649522	20'	"E" Fitting	1500 lb.	4500 lb.
649770	12'	Narrow	500 lb.	1500 lb.
649771	16'	Wire	500 lb.	1500 lb.
649772	20'	Hook	500 lb.	1500 lb.

**1" UTILITY RATCHET STRAPS "PACKAGED"**

ITEM #	STRAP LENGTH	END HARDWARE	W.L.L.	BREAKING STRENGTH
649012	12'	Wire Hook	1000 lb.	3000 lb.
649016	16'	Wire Hook	1000 lb.	3000 lb.

**1" UTILITY RATCHET STRAPS**

ITEM #	STRAP LENGTH	END HARDWARE	W.L.L.	BREAKING STRENGTH
649780	16'	Wire hk & D-ring	1000 lb.	3000 lb.
649781	20'	Wire hk & D-ring	1000 lb.	3000 lb.

**1" UTILITY RATCHET STRAPS**

ITEM #	STRAP LENGTH	END HARDWARE	W.L.L.	BREAKING STRENGTH
	16'	Snap Hook	1000 lb.	3000 lb.
	20'	Snap Hook	1000 lb.	3000 lb.

UTILITY TIE DOWNS ARE USED FOR MOST LIGHT DUTY RESTRAINT APPLICATIONS, pickup trucks, utility trailers, car top racks, boats, motorcycles and TV trailers.





650042



650041



650021



650022



650020



650024



650025



650001



650002



650003



650004



650040



650023



650000



650005



**Display Stand**

**ONE FREE DISPLAY STAND WITH THE ORDER OF ONE OR MORE START-UP KITS**

SEE NEXT PAGE FOR KIT QUANTITIES



650054



650051



650053



**Display Packaged  
CARGO CONTROL STRAPS**

NYLON WEBBING

**START-UP KIT  
QUANTITIES**



ITEM #	PACKAGE	SIZE	DESCRIPTION	WLL	
650000	4 Pack Combo	2 - 1"x10' 2 - 1"x6'	Ratchet Cam	400# 200#	3 pkgs.
650001	4 Pack	4 - 1"x15'	Ratchet	400#	4 pkgs.
650002	4 Pack	4 - 1"x6'	Cam	200 #	3 pkgs.
650003	4 Pack	4 - 1"x10'	Ratchet	300 #	2 pkgs.
650004	4 Pack	4 - 1"x15'	Ratchet with Rubber Handle	700 #	4 pkgs.
650005	4 Pack Combo	2 - 1"x6' 2 - 1"x10'	Cam - Camouflage Cam - Camouflage	200 # 200 #	3 pkgs.
650020	2 Pack	2 - 1"x15'	Ratchet	400#	5 pkgs.
650021	2 Pack	2 - 1"x6'	Cam	200#	3 pkgs.
650022	2 Pack	2 - 1"x10'	Ratchet	300#	2 pkgs.
650023	2 Pack	2 - 1.5"x15'	Ratchet with Rubber Handle	1000 #	6 pkgs.
650024	2 Pack	2 - 1"x15'	Ratchet with Rubber Handle	700 #	3 pkgs.
650025	2 Pack	2 - 1"x15'	Ratchet with Rubber Handle - Camouflage	400 #	3 pkgs.
650040	Single Pack	1 - 1.5"x15'	Ratchet with Rubber Handle	700 #	6 pkgs.
650041	Single Pack	1 - 1"x15'	Ratchet	400 #	4 pkgs.
650042	Single Pack	1 - 1"x10'	Cam	200#	4 pkgs.
650051	Single Bag	1 - 2"x 15'	Tow Strap		2 pkgs.
650053	10 Pack - 2 each	13", 18", 24", 30" 36"	Bungee Assortment		6 pkgs.
650054	6 Pack - 2 each	9", 15", 21"	Rubber Tie Down Assortment		8 pkgs.

930100 - Display Stand  
650027 - Starter Kit as listed above

**SINGLE**



**DUAL**



**TRIPLE**



**TRUCK TIRE CHAIN (ALSO AVAILABLE WITH STUDDED CROSS CHAIN)**

ITEM #	9/32"	ITEM #	5/16"	ITEM #	3/8" 9.5	TIRE SIZE
507950		508328		508342		10.00-20 11.22.5
				508341		10-R-20 11-R-22.5
507951		508350		508357		10.00-22 11-24.5
				508354		1-R-22 11-R-24.5
		508360		508368		11.00-20 12-22.5
						11-R-20 12-R-22.5
		508382		508370		12.00-20 12-R-20
		508403				12-24.5 11-R-22
						11.00-22 12-R-24.5
ITEM #	5/16"	ITEM #	3/8" 9.5	TIRE SIZE		
508329		508330		10.00-20 11-22.5		
				10-R-20 11-R-22.5		
508361		508400		10.00-22 11-24.5		
				10-R-22 11-R-24.5		
508380		508369		11.00-20 12-22.5		
508424				11-R-20 12-R-22.5		
				12.00-20 12-R-20		
ITEM #	3/8" 9.5	TIRE SIZE				
		10.00-20 11-22.5 10-R-20 11-R-22.5				
508358		10.00-22 11-24.5				
508355		10-R-22 11-R-24.5				
508367		11.00-20 12-22.5 11-R-20 12-R-22.5				
		12.00-20 12-R-20 11.00-22 12-R-24.5 11-R-22 12-R-24.5				

Available for most tire sizes.



**ATV V-BAR TIRE CHAIN 7/32"/5.5mm**

ITEM #	TIRE SIZE
525006	ht 20 Rim 9 hs 21 21x11x8 41x17
525001	(14 cross chains) 22x11x8 22x12x8
525003	(14 cross chains) 25x8x12 48 x 15
525004	(14 cross chains) 25x10x12 44x17
525015	25x12x9
525005	(14 cross chains) 24x11x10 51x21
525020	ht 25 Rim 10 hs 22 25x13x9x 48x19.25
520241	(14 cross chains) 23x10.5x12 56x14.5
525010	24x9x11

**CROSS CHAIN HOOK**



ITEM #	CHAIN SIZE
505055	7/32"
505063	1/4"
505080	5/16"
505100	3/8"
505110	7/16"

**QUICK LINK - ZINC**



ITEM #	SIZE	W.L.L.
503406	1/4"	880 lb.
503408	5/16"	1,540 lb.
503410	3/8"	1,980 lb.
503411	1/2"	3,300 lb.

**REPAIR LINK**



ITEM #	CHAIN SIZE
503706	1/4"
503708	5/16"
503710	3/8"
503713	1/2"

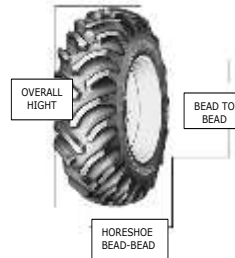

THREE TIRE DIMENSIONS ARE NEEDED TO ORDER THESE TIRES

**FORK LIFT TIRE CHAIN**

TIRE SIZE	CHAIN SIZE
508050 6.50 x 10	7/32"
508074 7.50 x 10	7/32"
508073 900 x 10	7/32"
508004 700 x 12	7/32"
508005 700 x 15	7/32"
508002 750 x 15 x 30	7/32"
508002 750 x 15 x 32	7/32"
508015 7.50 x 15 x 30	5/16"
508077 250 x 15	7/32"
508068 28 x 12.5 x 15	5/16"
508008 825 x 15	5/16"
508048 750 x 16	5/16"
508047 32 x 12.1 x 15	5/16"
508068 28 x 12.50 x 15	5/16"
508059 28 x 9 x 15	5/16"
508044 31 x 10.50 x 15	5/16"
508090 27 x 10.50 x 15	5/16"

**SIDE CHAIN**



ITEM #	SIZE	SIDE CHAIN
501053	1/4"	
501050	7/32"	
501086	5/16"	
501101	3/8"	
501125	7/16"	

**CROSS CHAIN**



ITEM #	SIZE	CROSS CHAIN
500055	7/32"	
500060	1/4"	Hardened
500081	5/16"	Hardened
500096	3/8"/9.5mm	Hardened
500110	7/16"	Hardened

**STUDDED CROSS**



ITEM #	SIZE	CROSS CHAIN
500208	5/16"	Studded
500210	3/8"	Studded
500211	7/16"	Studded

**CHAIN LOCKS**



ITEM #	CHAIN SIZE	
503009	1/4"	# 555
503015	5/16"	# 889
503014	3/8"	# 1011
ITEM #	CHAIN SIZE	
503016	5/16"	# 675
503018	3/8"	# 714

FOR MORE TIRE CHAINS SEE PRICE LIST

